

OCR

Oxford Cambridge and RSA

Friday 15 June 2018 – Afternoon

A2 GCE CLASSICS: CLASSICAL CIVILISATION

F388/01 Art and Architecture in the Greek World

Candidates answer on the Answer Booklet.

OCR supplied materials:

- 12 page Answer Booklet (OCR12)
(sent with general stationery)

Other materials required:

None

Duration: 2 hours**INSTRUCTIONS TO CANDIDATES**

- Complete the boxes on the Answer Booklet with your name, centre number and candidate number.
- Use black ink. HB pencil may be used for graphs and diagrams only.
- Answer **one** question from Section A and **one** question from Section B.
- Read each question carefully. Make sure you know what you have to do before starting your answer.
- Start your answer to each question on a new page.
- Write the number of each question answered in the margin.
- Do **not** write in the barcodes.

INFORMATION FOR CANDIDATES

- The number of marks is given in brackets [] at the end of each question or part question.
- In this paper you are encouraged to use diagrams, sketches, etc., where appropriate, to illustrate your answers.
- The total number of marks for this paper is **100**.
- The quality of written communication will be assessed in this paper.
- This document consists of **8** pages. Any blank pages are indicated.

INSTRUCTION TO EXAMS OFFICER/INVIGILATOR

- Do not send this Question Paper for marking; it should be retained in the centre or recycled. Please contact OCR Copyright should you wish to reuse this document.

Answer **one** question from Section A and **one** from Section B.

SECTION A – Commentary Questions

Answer **either** Question 1 **or** Question 2.

- 1 Study the photographs and answer the questions.



Statue A

Diskobolos



Statue B

Artemision Zeus

- (a) 'A vivid and convincing figure.' How far do you agree with this assessment of **Statue B**? [25]
- (b) By comparing **Statue A** and **Statue B**, explain which you think is the more innovative piece of sculpture. [25]

Do **not** answer this question if you have already answered Question 1.

2 Study the images and answer the questions.



Image A

The Propylaea on the Acropolis, Athens

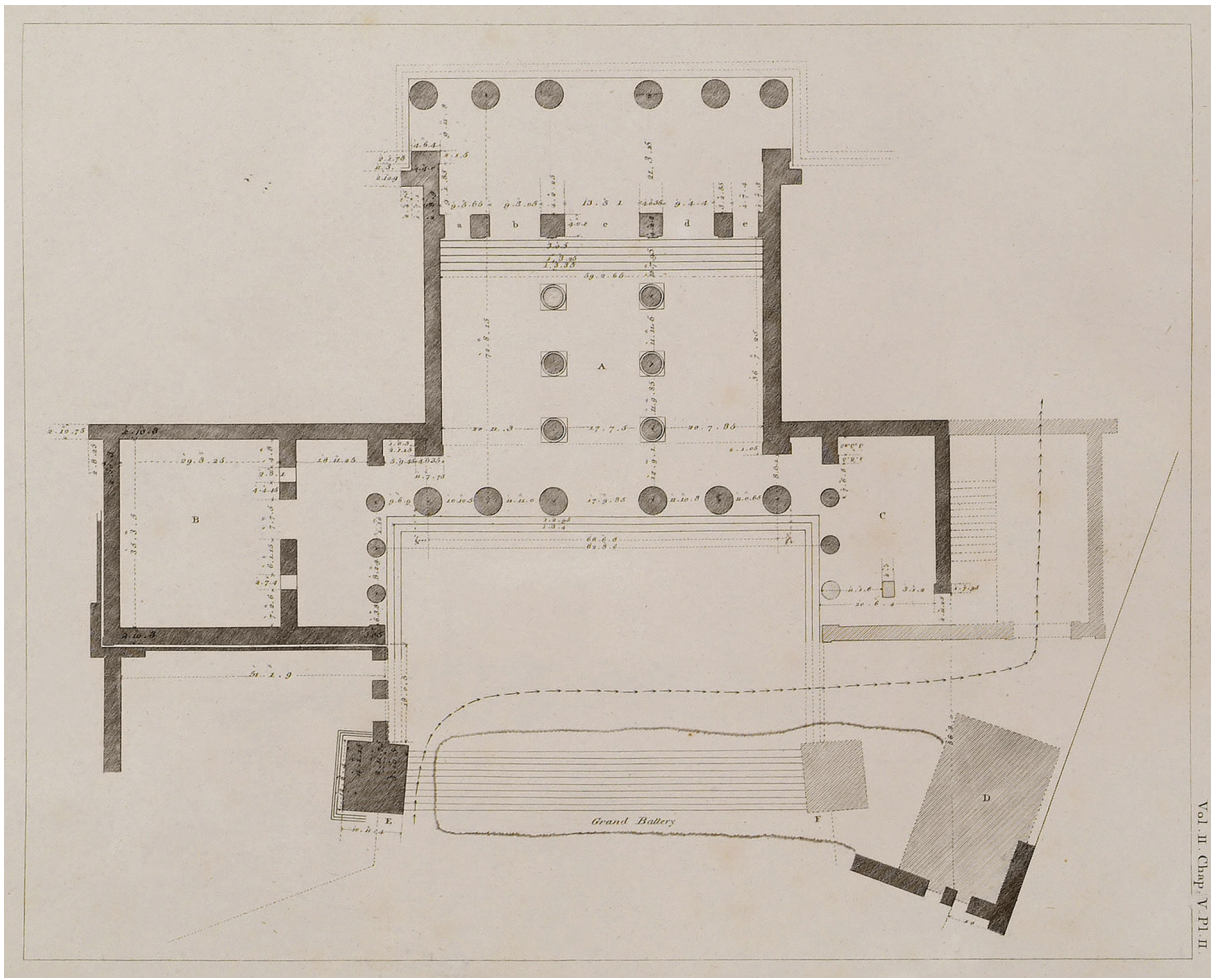

Image B

A plan of the Propylaea

- (a) Using the illustrations above as a starting point, consider how well the architect overcame the problems he faced when designing the Propylaea. [25]
- (b) 'An impressive and imposing structure, suitable for its purpose.' To which of the buildings on the Acropolis do you think this best applies? You should refer to **at least two** buildings in your answer. [25]

[Section A Total: 50]

SECTION B – Essays

Answer **one** question.

Start your answer on a new page.

- 3** ‘The portrayal of violent conflict provided the most satisfactory solution to the problem of filling space effectively.’ How far do you think this is true of the architectural sculpture you have studied? In your answer, you should include discussion of specific examples from at least **two** of pediments, metopes and friezes. **[50]**
- 4** How successfully did vase painters depict women as different from men? In your answer, you should discuss specific conventions and examples of pots. **[50]**

[Section B Total: 50]

END OF QUESTION PAPER

BLANK PAGE

**Copyright Information**

OCR is committed to seeking permission to reproduce all third-party content that it uses in its assessment materials. OCR has attempted to identify and contact all copyright holders whose work is used in this paper. To avoid the issue of disclosure of answer-related information to candidates, all copyright acknowledgements are reproduced in the OCR Copyright Acknowledgements Booklet. This is produced for each series of examinations and is freely available to download from our public website (www.ocr.org.uk) after the live examination series.

If OCR has unwittingly failed to correctly acknowledge or clear any third-party content in this assessment material, OCR will be happy to correct its mistake at the earliest possible opportunity.

For queries or further information please contact the Copyright Team, First Floor, 9 Hills Road, Cambridge CB2 1GE.

OCR is part of the Cambridge Assessment Group; Cambridge Assessment is the brand name of University of Cambridge Local Examinations Syndicate (UCLES), which is itself a department of the University of Cambridge.